

# GARDEN WALL/PARTIAL RETAINING

F



## CITY OF FULLERTON

303 W. COMMONWEALTH AVENUE  
 FULLERTON CA 92832  
 (714) 738-6541

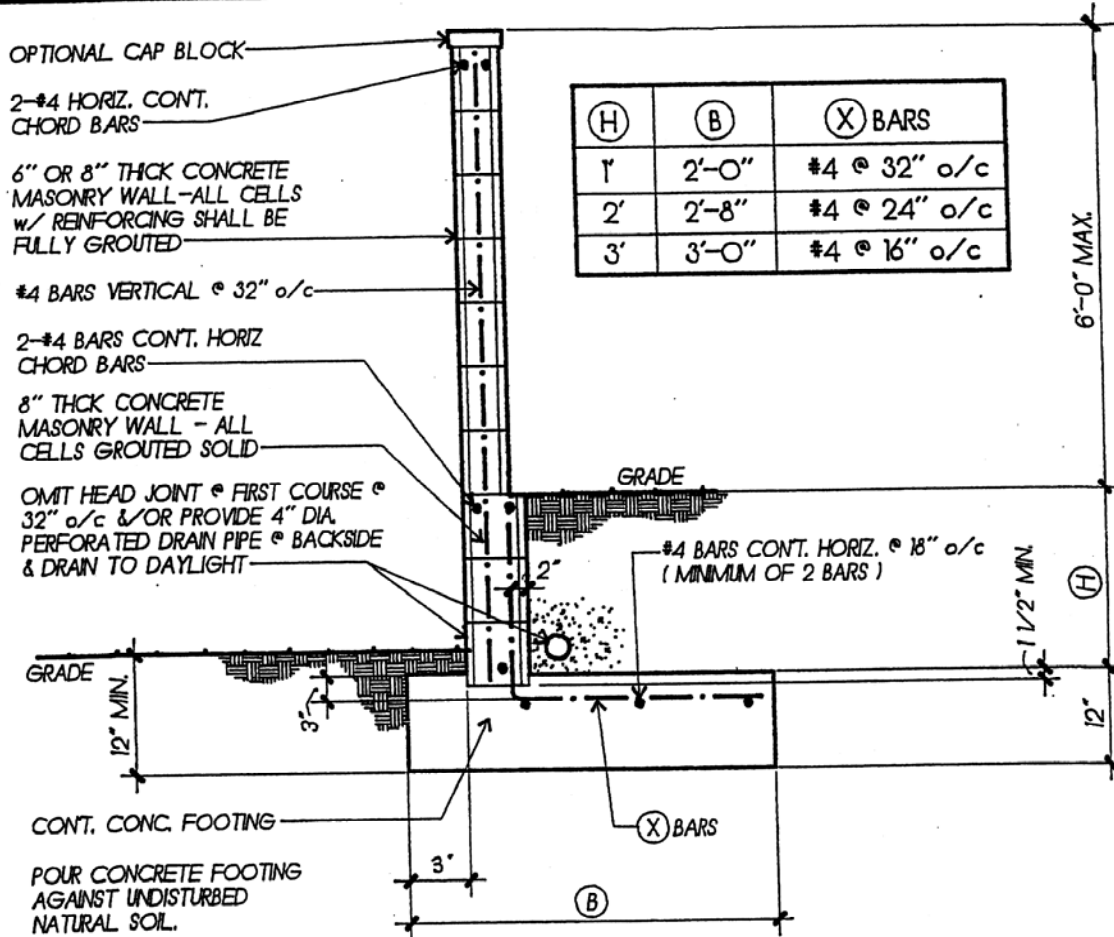

NOTES:

1. IT IS ASSUMED THAT THERE IS NO SURCHARGE ON THE WALL.
2. CONCRETE AND GROUT SHALL BE MACHINE MIXED, 2,500 P.S.I. @ 28 DAY ULTIMATE COMPRESSIVE STRENGTH
3. CONCRETE MASONRY BLOCK SHALL BE GRADE 'A' UNITS, PER A.S.T.M. C90-52
4. FINISH GRADE SHALL BE LEVEL ABOVE & BELOW THE WALL FOR A DISTANCE EQUAL TO THE "H" HEIGHT.
5. GROUT SHALL BE 1 PART CEMENT TO 3 PARTS SAND. ( MIN. 1500 P.S.I )
6. MINIMUM REINFORCING BAR LAP SHALL BE 40 BAR DIAMETERS
7. ALL BACKFILLS SHALL BE COMPACTED TO 90% DENSITY.